

ONE AND ONE-HALF INCH = ONE FOOT
 ONE INCH = ONE FOOT
 THREE-QUARTERS INCH = ONE FOOT
 ONE-HALF INCH = ONE FOOT
 ONE-QUARTER INCH = ONE FOOT
 ONE-EIGHTH INCH = ONE FOOT
 ONE-SIXTEENTH INCH = ONE FOOT
 ONE INCH = TWENTY FEET

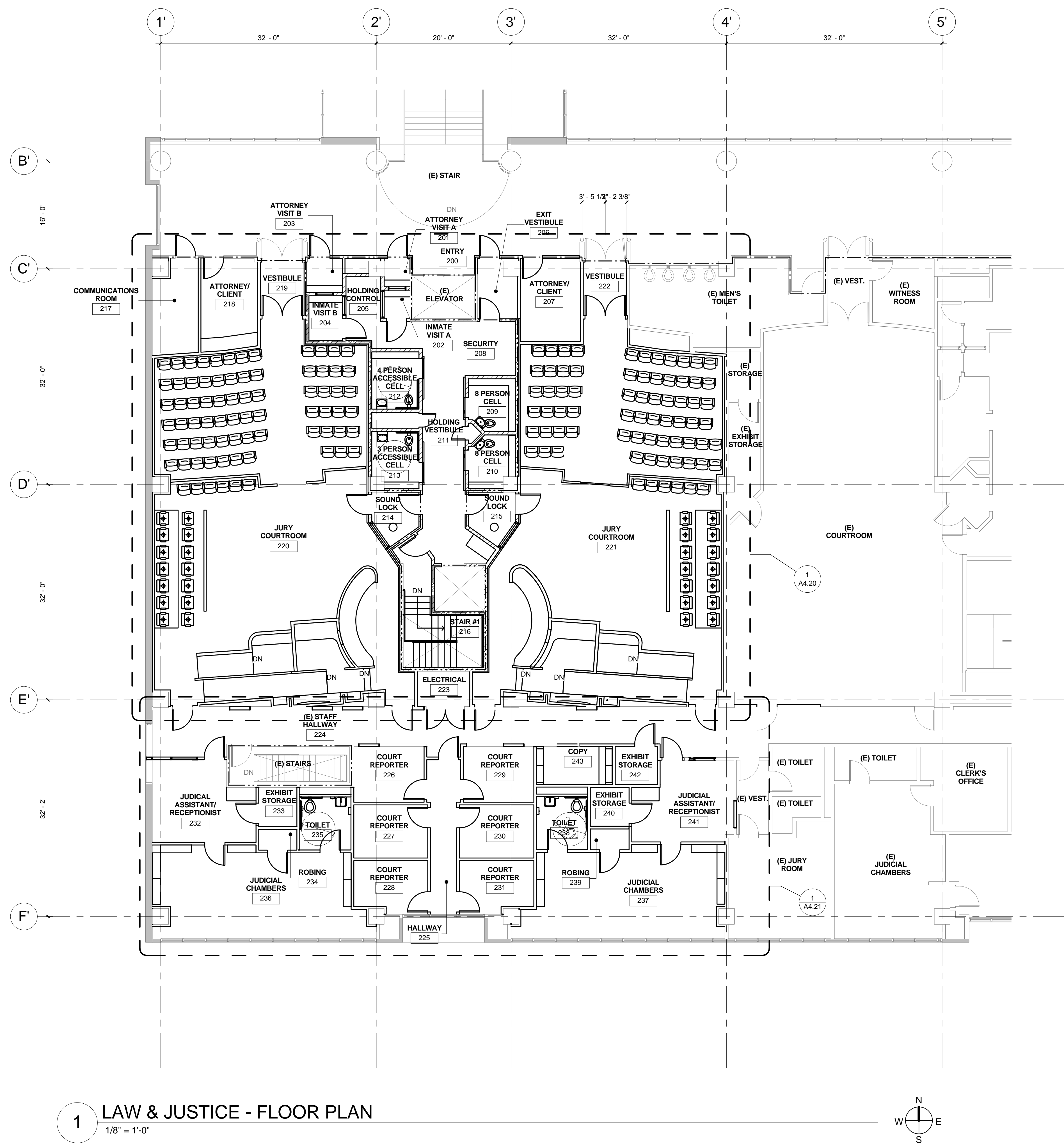

1 LAW & JUSTICE - FLOOR PLAN
 1/8" = 1'-0"

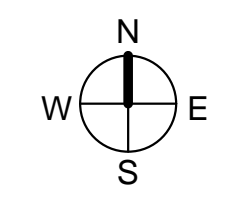

GENERAL NOTES:

- SEE SHEET T0.00 AND SPECIFICATIONS FOR GENERAL NOTES AND SCOPE OF WORK THAT MAY NOT BE COMPLETELY IDENTIFIED ON THESE SHEETS.
- SEE A8.00 FOR PARTITION TYPES.
- SEE A6.10 AND A6.20 FOR DOOR AND INTERIOR WINDOW TYPES.
- ALL DIMENSIONS TO EXISTING ITEMS ARE APPROXIMATE AND SHALL BE VERIFIED IN FIELD BY CONTRACTOR. DIMENSIONS TO NEW WORK ARE TO FACE OF STUD OR CONCRETE MASONRY UNIT, U.O.N.
- SEE A9.10 AND A9.20 FOR FURNITURE /EQUIPMENT PLANS.
- WHERE A RATED WALL INTERSECTS WITH AN EXTERIOR WALL, CONTINUE RATED ASSEMBLY TO INTERIOR FACE OF EXTERIOR WALL (BISECTING ANY FURRING AT INSIDE FACE OF EXTERIOR WALL).
- SEE A1.13 AND A1.20 FOR DEMOLITION PLANS.
- SEE A8.00 FOR RATED PARTITION HEAD DETAILS AT UNDERSIDE OF DECK AND FOR RATED THROUGH-WALL PENETRATION DETAILS.
- SEE A8.53 FOR FIRE EXTINGUISHER CABINET DETAIL.
- CONTRACTOR TO VERIFY & COORDINATE OPENING WIDTHS WITH REQUIREMENTS OF SELECTED DOOR/WINDOW SYSTEM.
- SEE 13/A5.22 FOR PLATFORM FRAMING PLAN AND DETAILS.

WALL LEGEND:

- 1 HOUR WALL
- 2 HOUR WALL
- 3 HOUR WALL
- (E) MASONRY WALL
- (E) CONCRETE WALL
- (E) STUD WALL
- (N) STUD WALL

CONSULTANTS

ARCHITECT



600 Q Street
 Suite 100
 Sacramento, CA 95811
 (916) 329-4000
 www.nlarct.com

50% DESIGN DEVELOPMENT SET

INITIAL BOX

NO.	DWG BY	DATE

REVISIONS

NO.	DESCRIPTION	DATE

DATE 12/12/08
 JOB NO. Y809.00
 SHEET TITLE
**SECOND FLOOR
 PLAN - L&J**

SHEET No.
A2.20
 SHEET ____ OF ____ TOTAL